

## TECHNICAL SPECIFICATION

### Mounting (DIN) rail

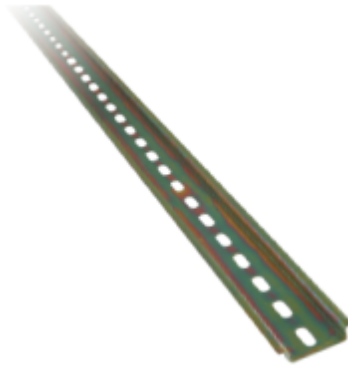

#### Functions:

- serves for mounting breakers, residual current devices, contactors and other elements
- provides a firm fixation of the elements

#### Technical data:

- brass alloy with galvanic cover
- factory drilled mounting openings
- length up to 1m

#### Connecting:

- with bolts or other fixing elements to the mounting surface

#### Dimensions:

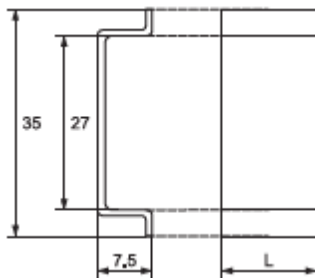

Length (m)	Packing / Box (pcs)	Catalogue number
1m	20 / 100	14001

